



ALTO

Configurable 4 channel alarm panel



PRESENTATION

- ▶ **Alarm panel** with 4 channels providing light and sound signaling for all types of sensors A.O.N. (all or nothing) particularly those intended for flood and fire detection.
- ▶ **9-32 VDC** power supply.
- ▶ **Line monitoring.**
- ▶ **Blinking LEDs** to identify unacknowledged alarms.
- ▶ **Customizable labels** to identify the channels.

FUNCTIONAL CHARACTERISTICS

Display

Visual signalling

- ▶ High efficiency LEDs : ON/OFF, line fault, alarm per channel.
- ▶ Blinking LEDs to identify the unacknowledged alarms.
- ▶ Customizable labels to identify the channels

Audible signalling

- ▶ Integrated buzzer 80dB.
- ▶ Buzzer output for use in noisy environments.

Functions

- ▶ 4 alarm channels for dry contact sensors.
- ▶ Configurable time delay per channel (0 / 10s).
- ▶ Type of sensor configurable per channel (N.O. / N.C).
- ▶ Configurable line monitoring activation per channel.
- ▶ Push button for LEDs test and acknowledgement.
- ▶ Reset push button (for fire detection).
- ▶ On/off push button in case of «sensitive» use.

Outputs

- ▶ Powered outdoor buzzer output.
(max 0.3A, 12/24 VDC)



MECHANICAL CHARACTERISTICS



Dimensions (LxWxH)

► L x l x H:
110 x 110 x 57 mm
(hors-tout)

► **Weight**
0.4Kg

► Installation

► Console mounting panel

ELECTRICAL CHARACTERISTICS

Power supply

- Voltage: universal input 9-32 VDC
- Intensity: 1A max. (incl. outdoor buzzer output)

Power supply protection

- overcurrent via fuse
- Polarity reversal on power supply by diode

Electrical connections

- Pluggable terminal blocks, capacity 1,5 mm²

REFERENCES & OPTIONS

- Wall mounted housing and cable glands.

CONNECTION OVERVIEW

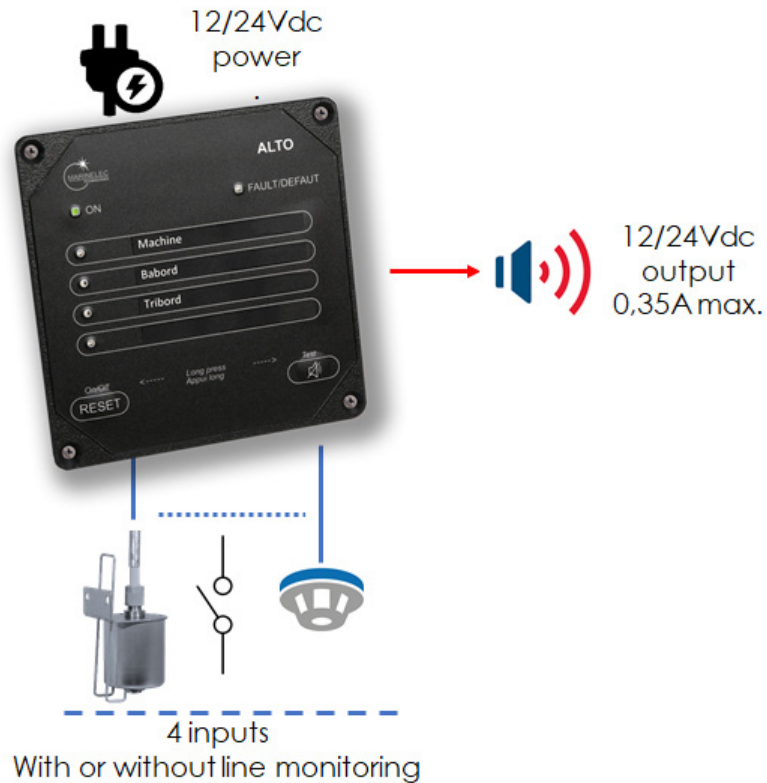

ENVIRONMENTAL CONDITIONS



Temperature limits

- -15°C to 70°C (storage)
- +5°C to 55°C (functioning)



Humidity

- 95% Humidity max.



Protection rating

- 44 (front panel)



Tel. + 33 (0)2 98 52 16 44 - Fax : + 33 (0)2 98 64 74 05 - marinelec@marinelec.com - www.marinelec.com

sail safely

