



SIRIUS

Warning and information
light column

PRESENTATION



- ▶ The SIRIUS light column is our innovative and aesthetic solution for effective audible and visual information in noisy areas.
- ▶ Our RGB LED technology for light animation allows for reduced weight and power consumption and flexibility in customization.
- ▶ Combined with our AVAS signal management system, our solution guarantees you a functional and quick to implement package.

FUNCTIONAL CHARACTERISTICS



Sirius light column

- ▶ 2 models:
 - ▶ 6 pictograms
 - ▶ 9 pictograms
- ▶ Control interface through a 2ml multiwire cable (included): +24Vdc, 0v, 1 contact per pictogram, 1 contact "test"
- ▶ Vertical or horizontal mounting with two clamps (included)
- ▶ Pictogram backlight: RGB LED. Color selection (according to IMO standard) thanks to integrated push buttons
- ▶ Pictogram symbol: passive stickers (according to IMO standard)
- ▶ Plug & play solution:
 - ▶ setting, animation and priority management of pre-programmed pictograms by using our AVAS system

Sirius junction box

- ▶ With or without sounder/beacon
- ▶ Sounder 24Vdc, 105db @ 1m, 3 stages control, up to 32 tones, MED approved for « Fire alarm »
- ▶ Multicolor LED beacon, 24vdc, green / red / orange color control

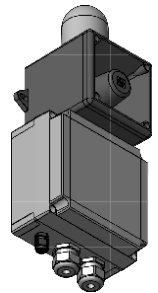

APPROVALS

Column conforms to the following regulations:

- IMO Resolution A686 (17)
- IMO Resolution A830 (19)



MECHANICAL CHARACTERISTICS



	Dimensions (HxWxD in mm)	Weight (Kg)	Mounting
SIRIUS_6V	103 x 802 x 130	0.9	surface: vertical or horizontal
SIRIUS_9V	103 x 1102 x 130	1.3	
SIRIUS_BJ	226 x 180 x 100	0.7	surface
SIRIUS_BJ_FS	443 x 180 x 134	1.2	surface

ELECTRICAL CHARACTERISTICS

Main power supply

- ▶ 24Vdc (+30% /-25%)

Consumption

- ▶ SIRIUS 6V:
55 mA /picto,
330mA max
- ▶ SIRIUS_9V:
55 mA /picto
495 mA max
- ▶ SOUNDER:
34mA @24VDC
BEACON:
110 mA

Electrical connection

- ▶ SIRIUS column:
2ml multiwire cable,
12x0.25mm²
- ▶ JUNCTION BOX:
18x 2.5mm² terminals
block

CONNECTION OVERVIEW

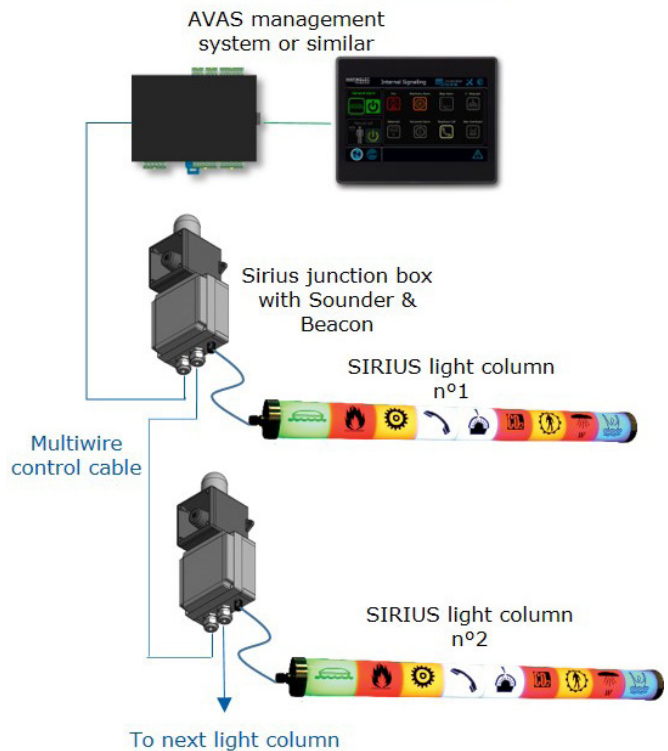

ENVIRONMENTAL CONDITIONS

Temperature limits

- ▶ 0°C to 55°C (functioning)
- ▶ 0°C to 70°C (storage)

Humidity

- ▶ 95% Humidity max.

Protection rating

- ▶ IP55

REFERENCES & OPTIONS

- ▶ SIRIUS_6V: Light column 6 pictograms (*)
- ▶ SIRIUS_9V: Light column 9 pictograms (*)
- ▶ SIRIUS_BJ: Junction box
- ▶ SIRIUS_BJ_FS: Junction box with sounder & beacon

(*) symbol & orientation of pictograms have to be indicated at the order



Tel. + 33 (0)2 98 52 16 44 - Fax : + 33 (0)2 98 64 74 05 - marinelec@marinelec.com - www.marinelec.com

sail safely

